

# Location of Wastewater Connection



Public Works Maintenance  
1820 Roosevelt Blvd.  
Eugene, Oregon 97402  
(541) 682-4800

### Property Information

Address 1352 HAYES ST

Map and Tax Lot \_\_\_\_\_ Owner \_\_\_\_\_

Building Type:  SFD  Duplex  Multi-Family  Commercial  Industrial

### Permit Information

Permit No. 23-08617-01 Date of Issue 12-4-23

Contractor/Plumber: PETERSON PLUMB Pipe Material SCH 40 Pipe Diameter 4"

Right of Way Cut Permit Required  System Development Charge

Installation Date 12-14-23 Inspected By REYNOLDS

*Permission granted to attach private sewer connection to public sewer in conformance to City standards and specifications.*

### Public Wastewater Information

Index Page No. 105C Segment No. 4849 4848 Inspected By \_\_\_\_\_  
Upstream Downstream Contract No. \_\_\_\_\_

TWO WORKING DAYS BEFORE YOU DIG, CALL UTILITY ONE-CALL SERVICE AT 1-800-332-2344  
TO ALLEY

UNABLE TO GET MEASUREMENTS FOR 40'S (DOGS IN YARD)

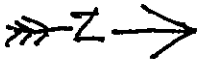
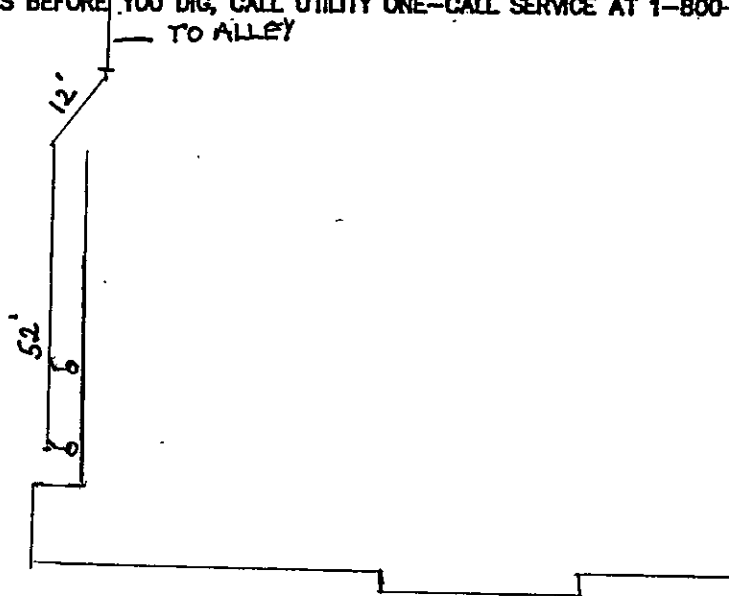

HAYES ST